

**FASTENING  
SYSTEM**  
*201 Vanguard*



CUPACLAD® 201 Vanguard stainless steel clips have been designed by our R&D department.

Every slate is fastened to the horizontal profile using two clips that remain partially visible once the system is installed.

## CUPACLAD® 201 Vanguard

MODERN AND EFFICIENT

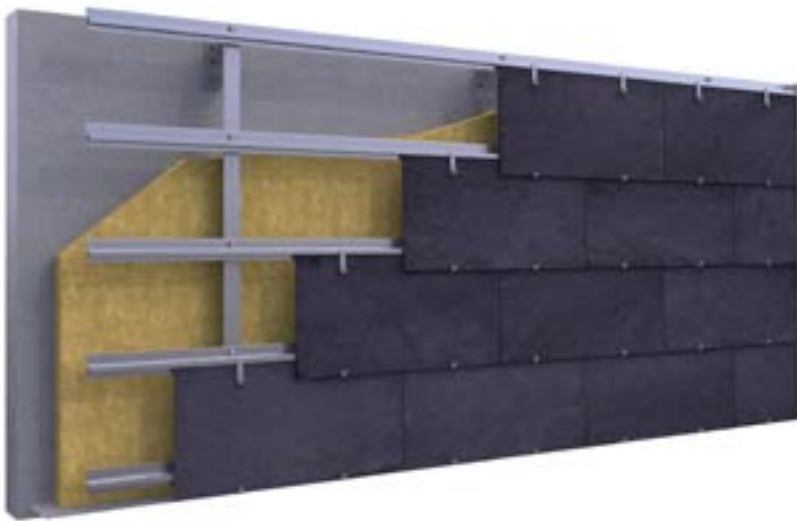

CUPACLAD® 201 Vanguard main feature is the combination of big slates and stainless steel brackets giving as a result a clean combination of contemporary appeal.

CUPACLAD® 201 Vanguard features 24 x 12 cm slates fitted horizontally with visible fixings.

Slate size	24 x 12
Nominal thickness	1/4 - 3/8
Slates per ft <sup>2</sup>	0.64
Weight per ft <sup>2</sup> (slate)	≤ 4,10 lb/ ft <sup>2</sup>



### PATENTED SYSTEM

CUPACLAD® 201 Vanguard is a patented system developed by our R&D department that is designed to meet the highest technical requirements of the construction industry.

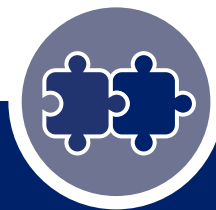

### EASE OF INSTALLATION

Our metal rails feature small holes in them to mark the exact position where the clips should be placed. This avoids the necessity of drawing vertical guidelines and individual fastening for the clips.



### PERFECT RESULT

The stainless steel clips have flanges that work just like a spring absorbing differences in the thickness of the slates resulting in a perfect leveled cladding surface.